

**Les Filtres Bleus  
Hautes Performances**



## SERVICE

FOR ANYTHING WITH A WORKING  
ENGINE THAT BREATHES AIR

### • SET THE CO RIGHT AFTER 30 MILES USE

Mechanical fuel injection engines  
Carburettor engines  
Two & four stroke engines

### • NO SETTING REQUIRED

Electronically controlled fuel injection  
Diesel and turbo charge diesel

## MAINTENANCE

### CAUTION

- Do not use petrol, high air
- pressure, steam or solvents
- For cleaning

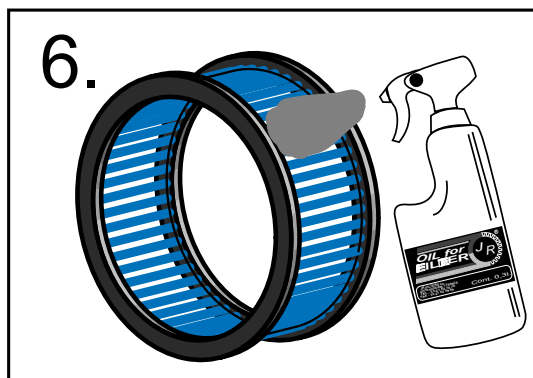
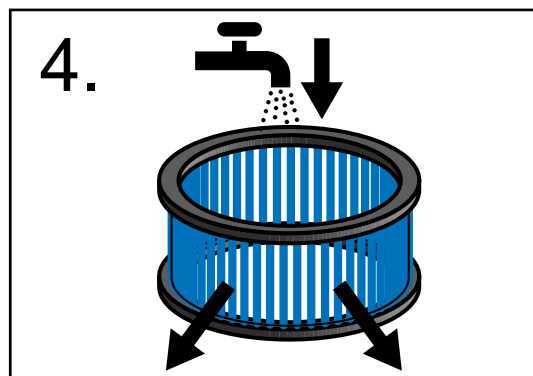
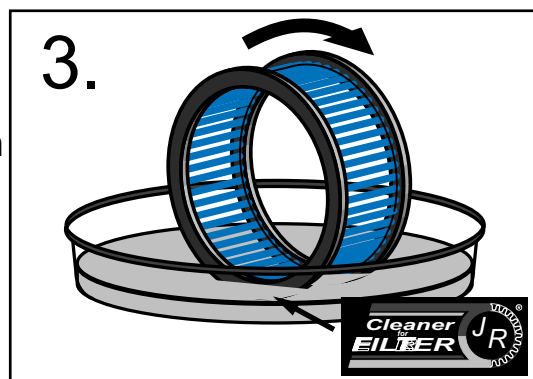

- 1.- Remove the filter and tap lightly to dislodge dirt.
- 2.- Wet the filter lightly with cold water.
- 3.- Roll the filter in a shallow bowl containing **JR FILTER CLEANER**, without allowing the inside of the element to become wet. Remove and leave for 15 minutes whilst the remaining dirt dissolves.
- 4.- Rinse off with warm water (not high pressure) from the inside outwards, washing away the dirt remnants.
- 5.- Allow the filter to dry naturally.
- 6.- Spray the filter lightly with **JR OIL SPRAY** and check for an even light blue colour.
- 7.- Refit the filter.

**JR Filter Cleaner :**  
5,0 L Réf : 100.5  
1,0 L Réf : 100.1

**JR Oil Spray :**  
0,3 L Réf : 101.0

# JR FILTERS

Z.A. RUE GALLIENI - 62150 HOUDAIN - FRANCE  
TEL : 0033 3 21 61 80 89 - FAX : 0033 3 21 61 80 85